



**OKADA**<sup>®</sup>  
Demolition Attachments

# QUICK COUPLER SE SERIES



# QUICK COUPLER SE SERIES

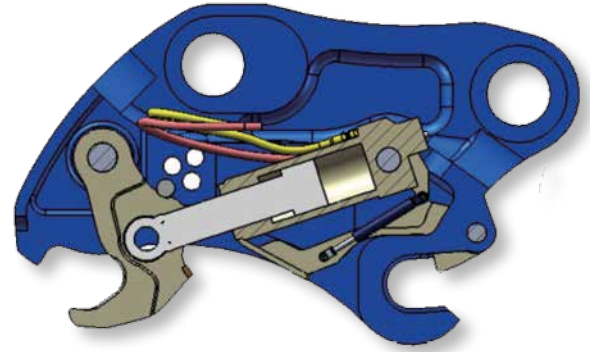
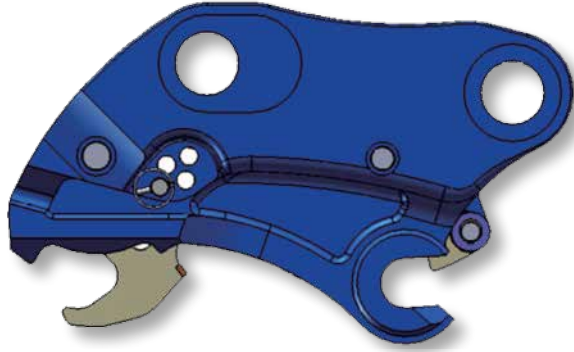

## Features of the Aiyon Coupler

- (1) Special steel casting integrated structure.
- (2) Safety is ensured through adopting a double lock autolock mechanism and mechanical lock mechanism unique to our company.
- (3) The structure is such that when the attachment is installed and the bucket pins are caught by the main body it is not necessary to check the position of the operating arm.
- (4) A relief valve attached to the hydraulic cylinder can handle unexpected excess impacts.
- (5) Greasing is not necessary thanks to the use of non-lubrication bushings with the bearing of each pin.
- (6) A wide range of installation configurations are available, from buckets to attachments.

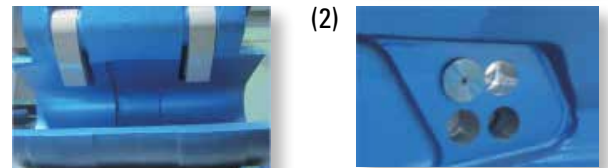

## SPECIFICATIONS

		SE350	SE450	SE850
Operating weight	lbs	1389	3220	3638
	kg	630	790	1650
Overall length	inches	44	46	57
	mm	1110	1160	1450
Overall width	inches	21	24	27
	mm	545	620	690
Overall height	inches	27	28	35
	mm	675	700	885
Pin diameter	inches	4	4	5
	mm	90	100	130
Pin center distance	inches	20-28	22-28	25-31
	mm	520-700	560-710	630-790
Anti-falling device	Fix side	Auto-locking		
	Arm side	Lock pin		
Carrier weight range	1000 lbs.	66-77	79-99	187-220
	metric tons	30-35	36-45	85-100



1. Please consult with us beforehand because the applicable inter-pin range differs depending on the attachment.
2. The above specifications are subject to change without notice.



## Okada America Inc.

12950 SE Hwy 212 Bldg. D  
Clackamas, OR 97015  
Tel: 503-557-7033  
Fax: 503-557-7779

904 Medina Rd.  
Medina, OH 44256  
Tel: 330-239-2666  
Fax: 330-239-3670

115 Commerce Blvd  
Cleburne, TX 76033  
Tel: 817-774-1295

[www.okadaamerica.com](http://www.okadaamerica.com)